

PCC790B

Prime Power: 570KW/713KVA

Standby Power: 630KW/788KVA

Voltage: 400V

Powered by Cummins KTA38-G1B Engine

Genset Performance

- 230/400V, 50Hz, 0.8PF, 3 Phases 4 wires
- Frequency drop $\leq 3\%$
- Voltage regulation $\leq 0.3\%$
- The steady state frequency $\leq 0.5\%$
- The steady state voltage deviation $\leq \pm 1\%$
- The transient frequency deviation $\leq +10\% \leq -15\%$
- The transient voltage deviation $\leq +20\% \leq -15\%$
- Frequency recovery time $\leq 3S$
- Voltage recovery time $\leq 1S(\text{Voltage} \pm 3\%)$
- THF (Telephone Harmonic Factor) < 3
- TIF (Telephone Influence Factor) < 50
- Comply to Standard NEMA MG1-22.43
- Built-in vibration isolator with high performance on shock absorption.

Standard Configuration

- Cummins Engine
- Brushless synchronous alternator
- POWERTEC intelligent controller
- 40°C standard ambient temperature (50°C Optional)
- Circuit breaker (3P)
- Float battery charger
- Battery connect wire
- Steel base frame
- Silencer, bellows, exhaust bend
- Manual book and files

Optional Items

- Starting batteries
- Fuel tank
- Oil-water separator
- Sensor for low coolant level, low fuel/oil level
- Automatically monitoring & controlling system of city power
- Coolant heater
- Oil heater
- Heat exchanger--Water cooled tower system
- Trailer
- 20GP or 40HQ container type canopy
- Design and construction of environmental protection engineering for the Genset room



Diesel Engine

- Model: **KTA38-G1B**
- Construction: replaceable wet type cylinder block has excellent radiation. Mature standard spare parts commonly apply to other engine in this series. Cylinder block and head will have no fault with the designment of internal oil passage and compact structure
- Cooling system: Adopt gear centrifugal water pump to cool down water temperature. With large flow channel designmeng ,it has good cooling performance;
- Fuel system: Cummins patented technology (PT) fuel system optimizes combustion and reduces emission;
- The engine may be operated at :
1800 RPM up to 5000 ft. (1525 m) and 104° F (40 °C) without power deration.
1500 RPM up to 5000 ft. (1525 m) and 104 ° F (40 °C) without power deration.
For sustained operation above these conditions, derate by 4% per 1,000 ft.(300 m), and 1% per 10 ° F (2% per 11 °C).

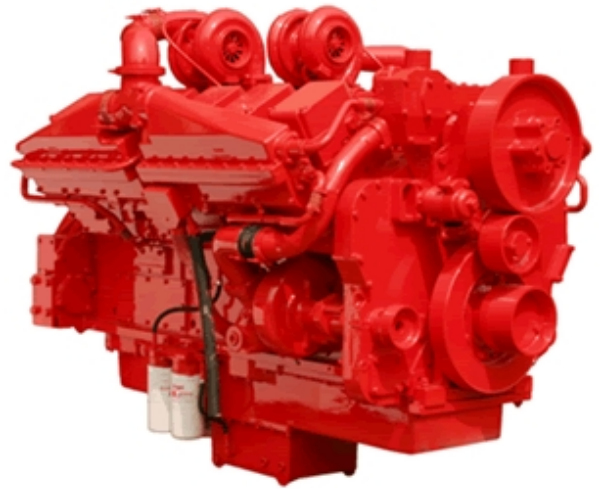

Alternator

- Optional brands: **Stamford / Marathon / Faraday / Engga / Mecc Alt**
- Brushless, 4 pole rotating magnetic field, single bearing with protective cover.
- Insulation: H Class.
- IP Class: IP23
- Cooling system
- AC exciter, rotate rectifying
- Rotor and exciter made with high temperature insulating resin, to satisfy tough environment.
- Rotor dynamic balancing complys for BS5625, class 2.
- Sealed with advanced lubricating grease to prolong life of bearing.



Standard

- 3 phases voltage: U_a, U_b, U_c
- Frequency F1
- Apparent power PR
- Power factor PF
- Coolant temperature WT
- Temperature °C display
- Oil pressure OP
- Engine speed
- 3 phases current: I_a, I_b, I_c
- Active power PA
- Power factor PF
- Temperature °C display
- KPa/Psi/Bar display
- Battery voltage V
- Running Hour
- Starting timer:(999999)



Standard Protection

Genset Protection

- Programmable I/O signal
- Emergency stop

Engine Protection

- Stop for over speed
- Low oil pressure
- High Coolant temperature
- Sensor fail
- Alarm for low/high battery voltage
- Low battery voltage
- Fail to start/Cranking fail

Alternator Protection

- Over Voltage
- Over current
- Voltage signal lost
- Over Voltage
- Over frequency
- Under frequency

Control System Components

- Manual/auto/stop/start
- Setting button
- Fault status indicators
- Screen menu selection button
- Emergency stop button
- Digital displayer



Communication Interface

(Option)

- International standard MODBUS communication protocol RS232/ RS485 is suitable for remote control and monitor; It is easy integrated with SCADA;.

Genset

Model	PCC790B
Prime Rating (kw)	570
Standby Rating (kw)	630
Rate voltage(V)	400
Rate current(A)	1028
Power factor	0.8
Frequency(Hz)	50

Engine

Engine Model	KTA38-G1B
Gross Engine output-Prime (kw)	634
Gross Engine output-Standby (kw)	701
Bore * stroke (mm)	159*159
Cylinders and structure	12 Cy lind, 60°Vee
Displacement(Liter)	38
Compression Ratio	14.5:1
Intake way	Turbocharged/Water-Air intercooler
Max intake resistance (KPa)	6.23
Air intake (m3/h)	2887
Max exhaust back pressure (KPa)	10
Exhaust gas flow (m3/h)	8122
Exhaust temp (°C)	538
Cooling way	Water Radiator & Fan
Fan exhaust flow (m3/min)	1140
Coolant capacity (L)	303
Highest water temperature(°C)	96
Minimum air opening to room (m2)	4.8/4.0
Thermostat range (°C)	82-93
Max oil temperature (°C)	121
Lubrication system oil capacity (L)	135
Rate load fuel consumption(L/H)	160
Standard Governor/Class	Electronic

Alternator

Rated Voltage(V)	230/400
Output Way	3 Phases, 4 wires
Rated power factor	0.8
Exciter	Brushless, Self-exciter
Max voltage regulation	±1%
Phase	3
Protection class	IP21-23
Insulation class	H

Controller

Brand	POWERTEC
-------	----------

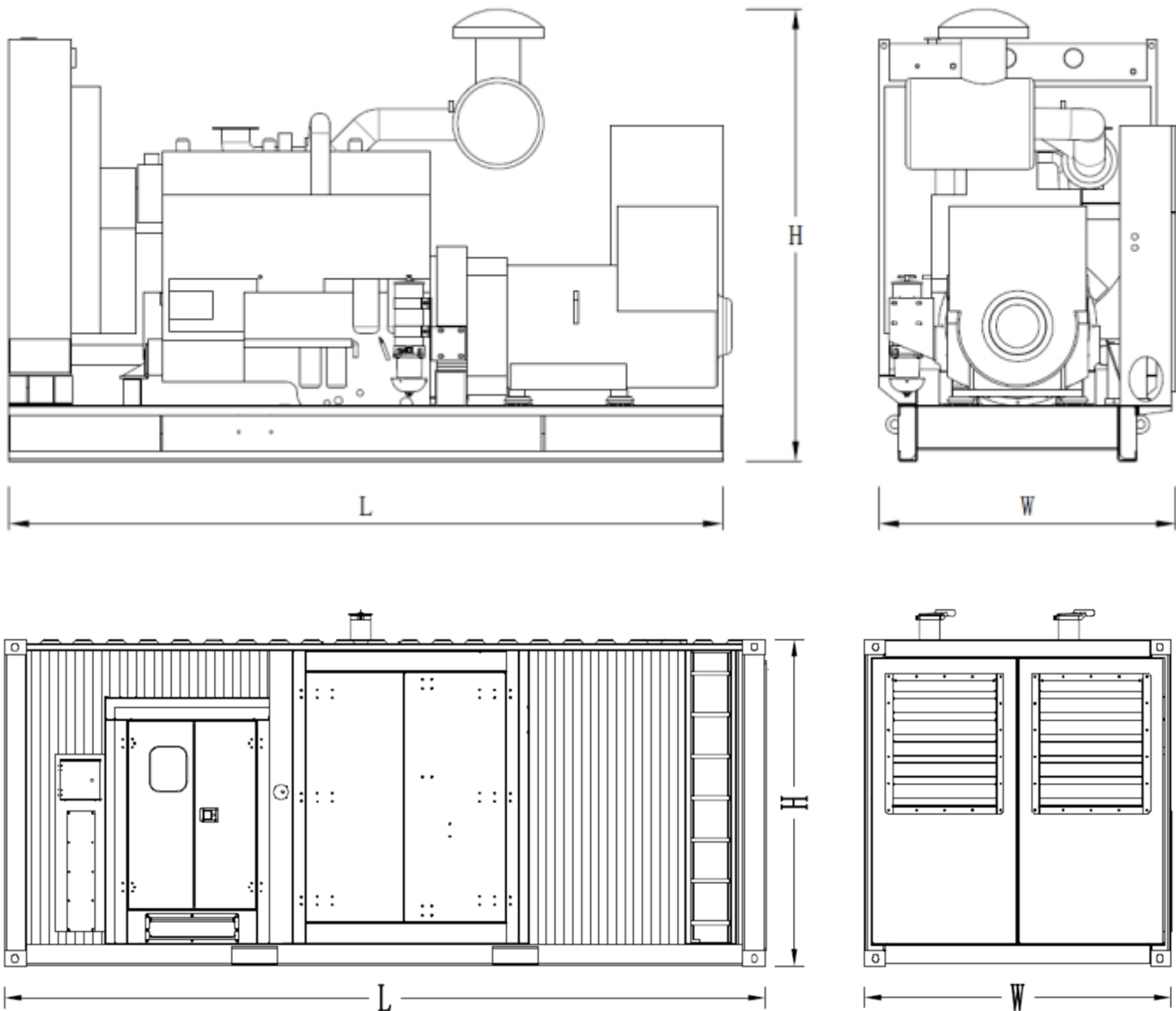

Type	Dimension (mm) (L*W*H)	Weight (kg)	Fuel Tank Capacity (L)
Open Type	4250*1770*2513	6400	—
Silent Type	6058*2438*2591	10600	1500

Contact Us

Powertec Generator System Inc.

Add: Danshui Yanna Industry Zone, Huiyang, Huizhou, Guangdong, China
Tel: +86 752-3911119 / 3911118
Fax: +86 752-3911110
Web: www.powertec.com.cn
Email: powertec@powertec.com.cn