

## PCC1540B

**Prime Power: 1120KW/1400KVA**

**Standby Power:1232KW/1540KVA**

**Voltage: 400VAC**

**Powered by Cummins QSK38-G30 Engine**

### Genset Performance

- 230/400VAC, 50Hz, 0.8PF, 3 Phases 4 wires
- Frequency drop  $\leq 3\%$
- Voltage regulation  $\leq 0.3\%$
- The steady state frequency  $\leq 0.5\%$
- The steady state voltage deviation  $\leq \pm 1\%$
- The transient frequency deviation  $\leq +10\% \leq -15\%$
- The transient voltage deviation  $\leq +20\% \leq -15\%$
- Frequency recovery time  $\leq 3S$
- Voltage recovery time  $\leq 1S(Voltage \pm 3\%)$
- THF (Telephone Harmonic Factor)  $< 3$
- TIF (Telephone Influence Factor)  $< 50$   
Comply to Standard NEMA MG1-22.43
- Built-in vibration isolator with high performance on shock absorption.

### Standard Configuration

- Cummins Engine
- Brushless synchronous alternator
- POWERTEC intelligent controller
- 40°C standard ambient temperature  
(50°C Optional)
- Float battery charger
- Battery connect wire
- Steel base frame
- Silencer, bellows, exhaust bend
- Manual book and files

### Optional Items

- Starting batteries
- Fuel tank
- Circuit Breaker
- Lubricate-water separator
- Sensor for low coolant level, low fuel/oil level
- City power monitoring & controlling system
- Coolant heater
- Oil heater
- Heat exchanger--Water cooled tower system
- 20GP or 40HQ container type canopy
- Trailer Type
- Environmentally design and construction of Genset room engineering for the Genset room

## Diesel Engine

- **Model: QSK38-G30**
- **Structure:** Replaceable wet cylinder liner, good heat dissipation effect, easy to replace; all model parts have strong versatility, high degree of serialization, and easy maintenance; both the cylinder block and cylinder head adopt built-in pressure lubrication oil passages, with compact structure and easy to troubleshoot Low rate.。
- **Cooling system:** forced water cooling by gear centrifugal water pump, large flow water channel design, good cooling effect; spin-on water filter and special DCA additive can effectively prevent rust and cavitation, control coolant acidity and remove impurities.
- **Fuel system:** Using the world's leading high-pressure common rail fuel system and fully electronic control module, ultra-high fuel injection pressure.。
- **Lubricating oil system:** pre-lubrication system, Centriguard centrifugal filter and CENTINEL continuous oil renewal system, two-stage combined Fleetguard oil filter, which can obtain a longer maintenance cycle and reduce the engine startup failure rate.。
- **Emissions compliance:**  
The improved combustion chamber shape allows the engine to achieve excellent emission levels without the need for post-processing, and has passed China's non-road stage three emission certification.。
- **The engine may be operated at :**  
1500 RPM up to 6900 ft. (2100 m) and 104 ° F (40 °C) without power deration.  
For sustained operation above these conditions, derate by 15.3% per 1,000 ft.(305 m), and 30% per 18 ° F (30% per 10 °C).



## Alternator

- **Optional brands: Stamford / Marathon / Faraday / Engga / Mecc Alt**
- Brushless, 4 pole rotating magnetic field, single bearing with protective cover.
- **Insulation: H Class.**
- **IP Class: IP23**
- **Cooling system**
- **AC exciter, rotate rectifying**
- Rotor and exciter made with high temperature insulating resin, to satisfy tough environment.
- Rotor dynamic balancing complys for BS5625, class 2.5
- Sealed with advanced lubricating grease to prolong life of bearing.



## Standard

- 3 phases voltage: Ua, Ub, Uc
- Frequency F1
- Apparent power PR
- Power factor PF
- Coolant temperature WT
- Temperature °C display
- Oil pressure OP
- Engine speed
- 3 phases current: La, Lb, Lc
- Active power PA
- Power factor PF
- Temperature °C display
- KPa/Psi/Bar display
- Battery voltage V
- Running Hour
- Starting timer:(999999)



## Standard Protection

### Genset Protection

- Programmable I/O signal
- Emergency stop

### Engine Protection

- Stop for over speed
- Low oil pressure
- High Coolant temperature
- Sensor fail
- Alarm for low/high battery voltage
- Low battery voltage
- Fail to start/Cranking fail

### Alternator Protection

- Over Voltage
- Over current
- Voltage signal lost
- Over Voltage
- Over frequency
- Under frequency

### Control System Components

- Manual/auto/stop/start
- Setting button
- Fault status indicators
- Screen menu selection button
- Emergency stop button
- Digital displayer



## Communication Interface (Option)

- International standard MODBUS communication protocol RS232/ RS485 is suitable for remote control and monitor; It is easy integrated with SCADA.

Genset	
Model	PCC1540B
Prime Rating (kw)	1120
Standby Rating (kw)	1232
Rate voltage(V)	400
Rate current(A)	2021
Frequency(Hz)	50
Engine	
Engine Model	QSK38-G30
Gross Engine output-Prime (kw)	1239
Gross Engine output-Standby (kw)	1371
Bore * stroke (mm)	159*159
Cylinders and structure	12 Cylinder ; Vee
Displacement(Liter)	37.7
Compression Ratio	14.2:1
Intake way	Turbocharged and Charge Air Cooled
Max intake resistance (KPa)	6.2
Air intake (m3/h)	5828
Max exhaust back pressure (KPa)	10.1
Exhaust gas flow (m3/h)	13694
Exhaust temp (°C)	473
Cooling way	Water Radiator & Fan
Fan exhaust flow (m3/min)	1140
Coolant capacity (L)	310
Highest water temperature(°C)	110
Minimum air opening to room (m2)	7.1/5.9
Thermostat range (°C)	85-95
Max oil temperature (°C)	130
Lubrication system oil capacity (L)	121.5
Rate load fuel consumption(L/H)	290
Standard Governor/Class	Electronic Fuel Injection
Emission	China CS III
Alternator	
Rated Voltage(V)	400/230
Output Way	3 Phases, 4 wires
Rated power factor	0.8
Exciter	Brushless, Self-exciter
Max voltage regulation	±1%
Phase	3
Protection class	IP21-23
Insulation class	H
Controller	
Brand	POWERTEC

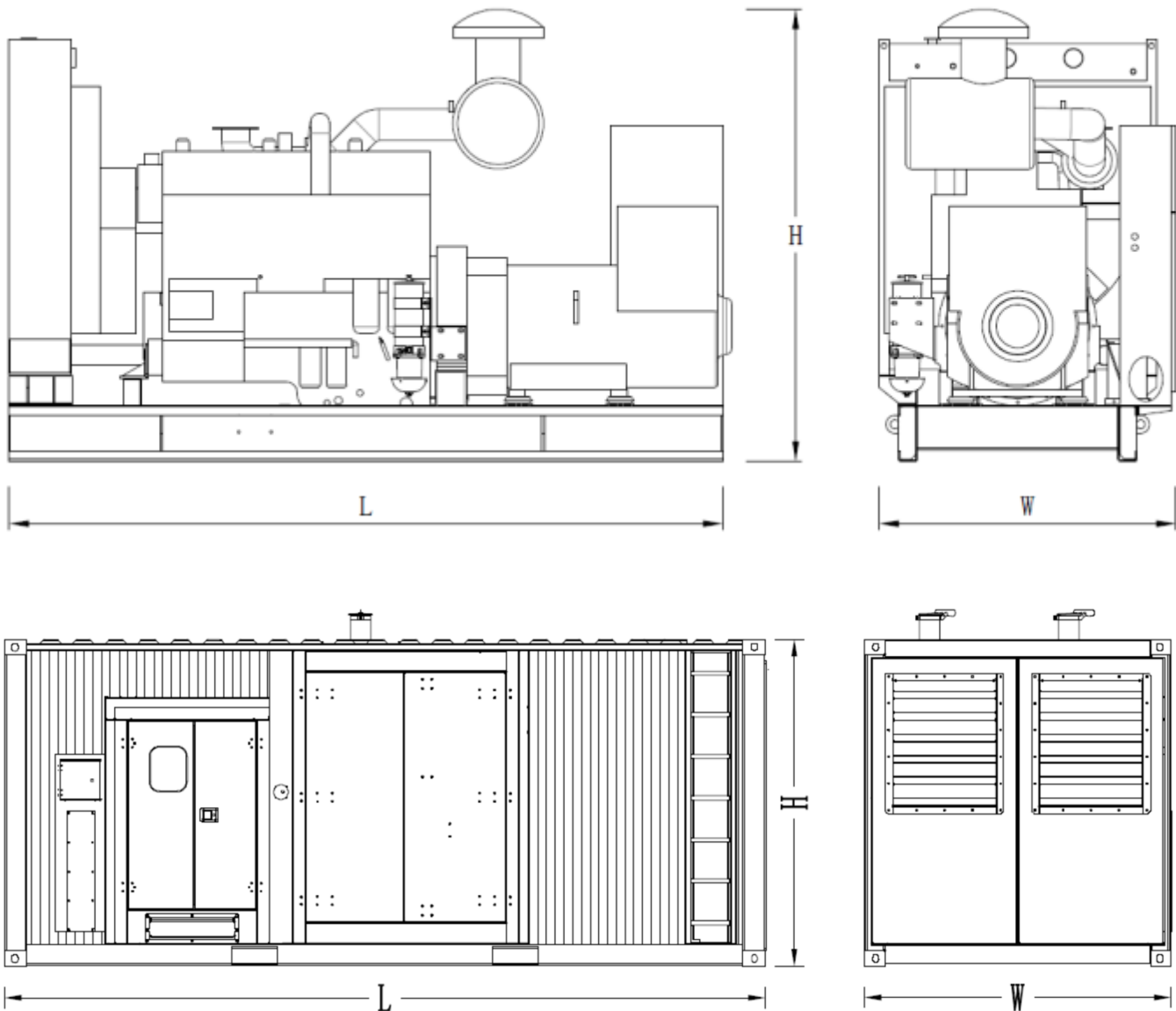

Type	Dimension (mm) (L*W*H)	Weight (kg)	Fuel Tank Capacity (L)
Open Type	5100*2435*2259	9000	/
Silent Type	/	/	/

Contact Us

**Powertec Generator System Inc.**

**Add:** Danshui Yanna Industry Zone, Huiyang, Huizhou, Guangdong, China

**Tel:** +86 752-3911119 / 3911118

**Fax:** +86 752-3911110

**Web:** [www.powertec.com.cn](http://www.powertec.com.cn)

**Email:** [powertec@powertec.com.cn](mailto:powertec@powertec.com.cn)